



Creekstone Estate,
Tarneit VIC 3029

Lot 810, Creekstone

\$903,904

 4 Bedrooms

 2 Bathrooms

 2 Garage

 313.00m² Land



Renders are indicative only.

- I. Master Plan
- II. House & Land Package
- III. Floor Plan
- IV. Site Plan
- V. Full Turn-key Inclusions
- VI. Facade
- VII. Location: Tarneit
- VIII. Photos



CREEKSTONE

TARNEIT

Creekstone Estate, Tarneit (VIC 3029) is a vibrant, master-planned community by Macson Developments, situated in Melbourne's growing western corridor. Designed for "Life Ready" families, the estate boasts over 30 hectares of green space, natural waterways, and direct access to the Skeleton Creek reserve, creating a beautiful setting for active living. It offers a mix of titled land and full turnkey house-and-land packages, with an emphasis on high-quality, 7-Star energy-rated homes. Convenience is key, with the established Nearnung Primary School already open on-site, a future school planned, and immediate access to Tarneit Central Shopping Centre and Tarneit train station. Creekstone is an inclusive, thriving community where over 950 families have already chosen to build their future.



Lot 810, Creekstone

🛏️ 4 🚿 2 🚗 2

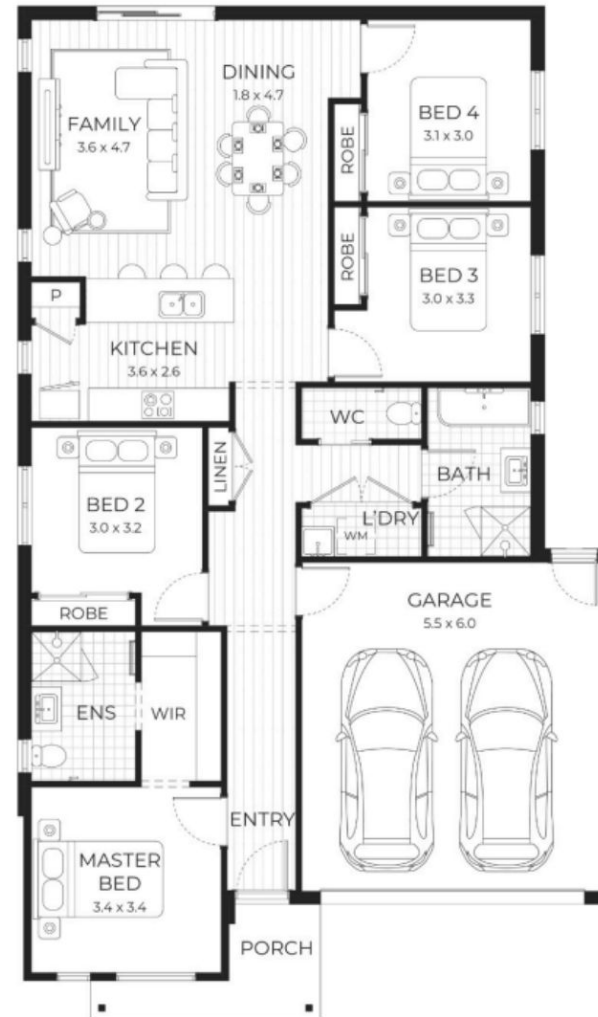

📐 LAND SIZE
313.00 m²

🏠 BUILD SIZE
175.91 m²

*Plan may be mirrored subject to driveway location.

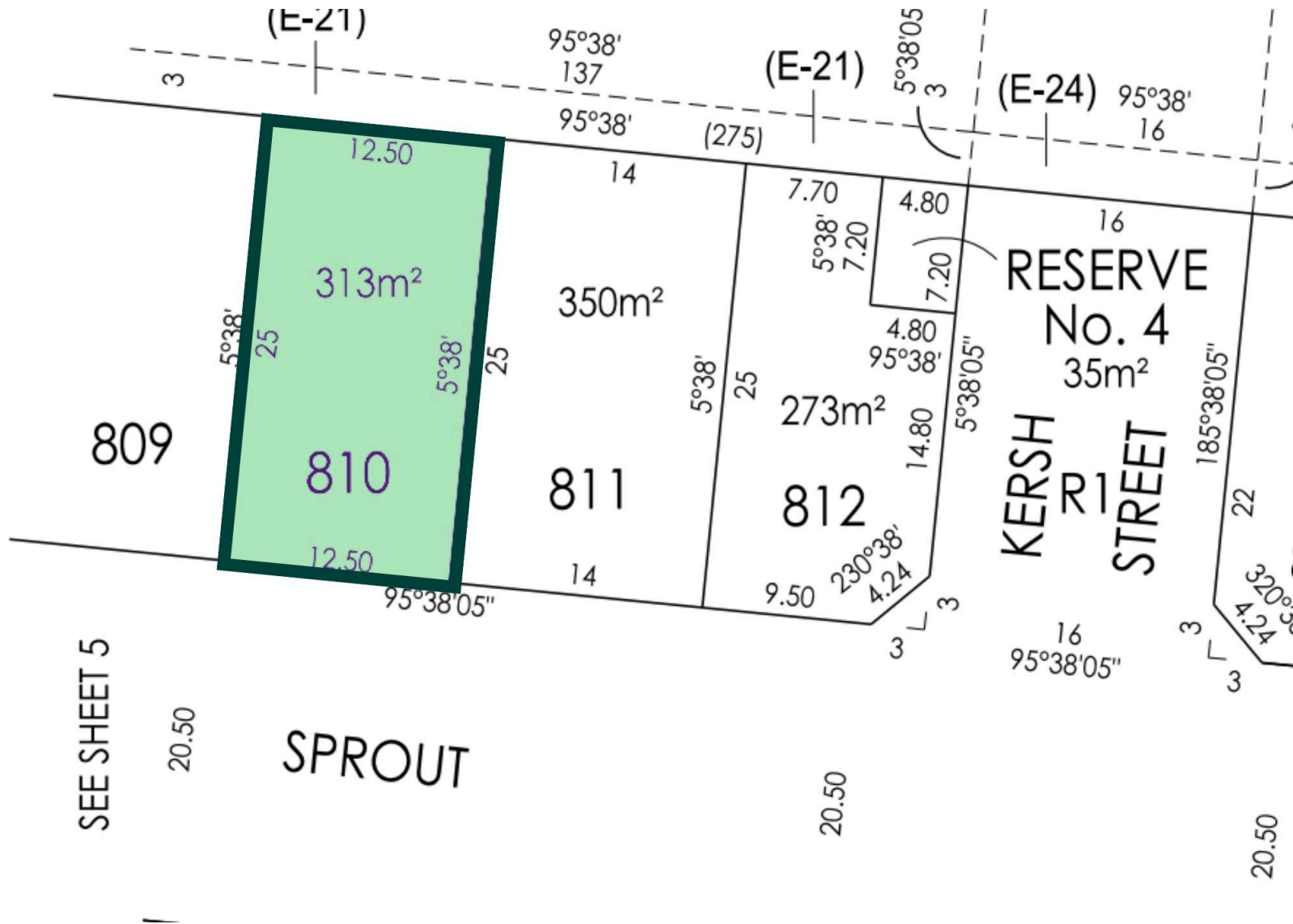

- Fixed-price full turn-key home and land package
- 7-star energy rating
- Double-glazed windows throughout
- 2590mm ceiling heights to ground floor
- 20mm stone benchtops to kitchen, ensuite, and bathroom
- Vinyl sliding doors to robes
- Landscaping to front and rear as per developer requirements
- Timber flooring and carpet throughout
- White LED downlights throughout
- Premium chrome tapware with exclusive extended warranty
- Lifetime structural guarantee





RENDERS ARE INDICATIVE ONLY

Disclaimer. All Images are illustrative and may not accurately represent actual colours or finishes of depicted products. Room layouts depicted are illustrative and may not represent the final layout of your home. All screens & printers display images differently, no warranty is made as to the accuracy of the images device/printed material they're being viewed on. Items may be subject to stock availability at the time of order, some items may be substituted to a similar or equivalent product. Consult your building tender or contract for all inclusions.

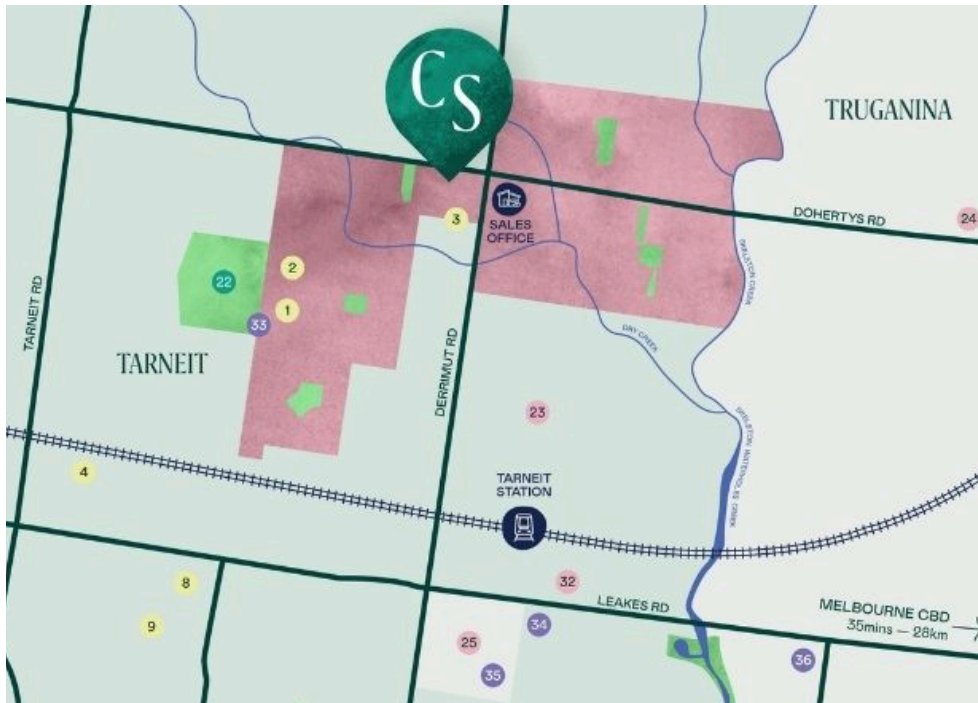



ABOUT THE LOCATION

Tarneit (VIC 3029), located about 25 km west of Melbourne in the City of Wyndham, is well-served by road links and the Tarneit rail station, offering solid connectivity to the CBD. Rich in green space and recreational options, it offers walking trails, parks, community events, and a multicultural, family-oriented lifestyle. The property market is dynamic and expanding, driven by sustained population growth. Local services include schools, shopping precincts like Tarneit Central and planned major retail hubs, medical centres and recreation facilities. Why choose Tarneit? It balances suburban affordability with connectivity, growth potential, community spirit and a forward-looking infrastructure base—ideal for families and investors.

- 

Masterplanned
COMMUNITY
- 

11 mins.
WERRIBEE MERCY HOSPITAL
- 

5 mins.
TARNEIT CENTRAL SHOPPING CENTRE
- 

2 mins.
LOCAL CREEKSTONE PARK
- 

3 mins.
NEARNUNG PRIMARY SCHOOL
- 

2 mins.
TARNEIT TRAIN STATION
- 

2 mins.
SKELETON WATERHOLES CREEK
- 

7 mins.
PACIFIC WERRIBEE

FOR INQUIRIES, CALL US:

0434190184

FOLLOW US IN SOCIAL MEDIA

CONTACT

Nick Klappas

nick@elitewealthcreators.com

0434190184
