



SMSF Suitable

**\$617,000.00**

 3    2    1

**Lot 1542, 12 Bindaree Drive, Melton South**

Land Size	213m <sup>2</sup>
House Area	180m <sup>2</sup>
Completion Forecast	June-26

### Rental Estimate

3 Bedrooms	\$440/week
Total Yearly	<b>\$22,880</b>

### Features & Inclusions:

- 2740MM Ceiling Height
- 2340mm High Doors
- 40mm Stone Benchtops to Kitchen
- 20mm Stone Benchtops to Bathrooms
- Upgraded Bathroom Vanities
- Tiled Shower Bases
- Upgraded Tapware
- Upgraded Door Handles
- Kitchen Appliances
- Overhead Cabinets in Kitchen
- Laminate/Tiled Flooring
- Front and Rear Landscaping
- Holland Blinds
- Heating & Cooling
- Much Much More.....

*10% Deposit*

*Balance at Settlement*

-  Turnkey
-  Growth Corridor
-  High Upgrades
-  Low Maintenance
-  7 Star Energy Rating

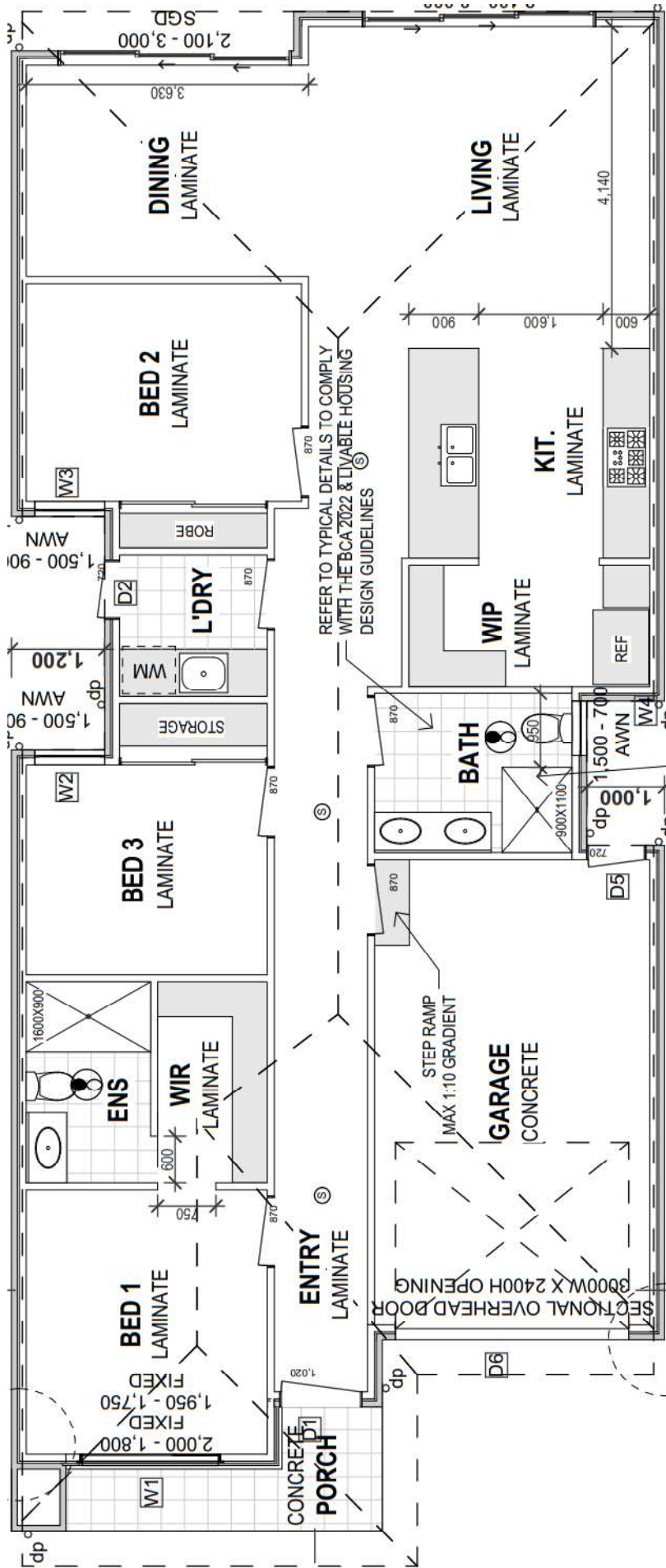



orchard  
Green

The **Perfect** Place to Live





Rees Rd

Woodgrove Shopping Centre

Western Freeway

Melton South Primary School

Exford Rd

Bunnings

Al Iman College

Melton Train Station

Melton Station Square shops

Orchard Green Parkland

Orchard Green Wetland

Future Road

Proposed Sporting Reserve

Proposed Govt School



Opalia Plaza



Exford Rd



Exford Rd

Walton St

Orchard Green Parkland

Orchard Green Wetland

Rees Rd

Opalia Shopping Centre Under Construction

Proposed Govt School

Proposed Sporting Reserve

Existing Homes

Existing Homes



orchard  
GREEN



  
orchard  
Green



*Naturally – The Perfect Place to Live, Orchard Green is the most sought after residential estate in Melton South. Conveniently located only minutes to respected public and private schools, train station and great local parks. Orchard Green Estate offers a variety of premium allotments welcoming a community for people looking to make a new start.*

Register your interest today to be part of this new and vibrant community.

[orchardgreen.com.au](http://orchardgreen.com.au)

Call 1300 452 766

**JASON**  
real estate

THIS BROCHURE IS FOR INFORMATION PURPOSES ONLY AND IS INTENDED TO BE GENERAL IN NATURE. ALL IMAGES, ILLUSTRATIONS AND RENDERS ARE FOR PRESENTATION PURPOSES, ARE NOT ACTUAL IMAGES OF THE DEVELOPMENT AND ARE INTENDED TO BE INDICATIVE ONLY. EVERY CARE IS TAKEN TO ENSURE INFORMATION CONTAINED IN THIS PUBLICATIONS IS ACCURATE AT THE DATE OF PRINTING HOWEVER ORCHARD GREEN CANNOT GUARANTEE IT'S ACCURACY AFTER THAT TIME. PROSPECTIVE PURCHASERS SHOULD CAREFULLY REVIEW ANY CONTRACT OF SALE, ENDORSED PLANS MAKE THEIR OWN ENQUIRIES AND OBTAIN INDEPENDENT ADVICE BEFORE PROCEEDING. THE LOTS SIZES, LAYOUT AND MEANS OF ACCESS MAY CHANGE WITHOUT NOTICE, THE DEVELOPER AN REAL JASON REAL ESTATE RESERVES THE RIGHT TO WITHDRAW OR ALTER ANY LOT OR STAGE LAYOUT AT ANY TIME AT ITS ABSOLUTE DISCRETION.